

ProFace X

Outdoor & Vandal-resistant Facial Recognition Terminal



ProFace X is a fully upgraded version of the ProFace product line, which is designed to deal with all kinds of scenarios. It's powered by the latest ZKTeco-customized CPU for running the intellectualized engineering facial recognition algorithm to boost up the performance in all aspects.

With its powerful core and the latest facial recognition algorithm, the ProFace X facial recognition capability has reached a new height in the biometrics industry with a maximum of 100,000 (optional) facial templates, facial recognition speed less than 0.3 sec per face, ultimate anti-spoof ability against almost all types of fake photos and videos attack .

Other than the powerful core, ProFace X is also equipped with the latest face capture system, which enables the terminal to recognize faces under extreme strong light conditions (50,000 lux), and a microwave detector to precisely evaluate the distance between the user and the device for waking up the terminal.

ProFace X comes with a robust design that can work in extreme weather conditions from -30°C (-22°F) to 60°C (140°F); The IP68 dust and waterproof standard and IK04 protection standard also enhance its outdoor durability.

Features

- Ultra-large capacity of facial templates; 1:N - 30,000 facial templates (standard), maximum 1:N - 100,000 (optional) facial templates (optional)
- Rapid facial recognition within 0.3s
- Anti-spoofing algorithm against print attack (laser, color and B/W photos), videos attack, and 3D mask attack
- Intelligent energy-saving design, precisely evaluates the distance up to 2.5m (8.2ft) between the user and the device by a microwave detector before waking up the recognition terminal
- Integrated 125kHz prox card reader (optional IC Card)
- 2MP starlight CMOS sensor camera with WDR function, which enables the terminal to recognize faces under extreme lighting conditions (0.5 lux – 50,000 lux)
- Supplement lighting with adjustable brightness
- 8" touch screen with 400 lux, which offers high visibility under strong and direct light
- Multiple communication methods: TCP/IP, RS485, RS232, Wi-Fi (optional)
- IP68 dust-proof and waterproof standard and IK04 protection standard
- Wide range of working temperature (-30 ~ 60°C; -22 ~ 140°F)

Specifications (G: GL Exclusive Feature)

Capacity

G Faces	30,000 (1:N) 100,000 (1:N Optional)
Palm	5,000
Users / Cards	50,000
G Transactions	100,000 (Optional) 2,000,000
User Photos	10,000
Event Photos	10,000

* **Note:** ProFace X with the optional 100,000 faces capacity, it does not support the following features: photo saving function and video intercom function.

Compatibility

Security Relay Box
Wiegand / RS485 / RS232 Slave Reader
with FP / RFID / Barcode / QR-code
ZKBio CVSecurity

Access Control Interface:

Lock Relay Output
Alarm Output / Auxiliary Input
Exit Button / Door Sensor

Hardware

- G 900MHz Dual Core Customized Computer Vision CPU
- G 512MB RAM / 8G Flash
- G 8" (400lux) IPS Touch LCD
- G 125KHz EM Reader / 13.56MHz MF(Optional)
- 2MP WDR Low Light Camera
- Adjustable Light brightness LED
- Hi-Fi Voice
- Receiver sensitivity Microphone
- Distance Detection Sensor
- Reset Button and Tamper Switch

Special Functions:

- G IP68 & IK04
- G 0.3s High Speed Face Verification
- Live Face detection
- Communication Https Encrypted Optional
- G Event Snapshot

Standard Functions:

Access Levels, Groups, Holidays, DST, ,
Duress Mode (Password), Anti-Passback,
Record Query, Custom Wallpaper & Screen
Saver, Tamper Switch Alarm

Communication

TCP/IP
Wiegand Input / Output
Wi-Fi (Optional)
RS485 / RS232

Additional Info

Face Algorithm: ZKLiveFace5.8
Working Temperature: -30°C ~ 60°C,
(-22°F ~ 140°F)
Working Humidity: ≤93%
Storage Temperature: -40°C ~ +65°C
Storage Humidity: ≤93%
Net Weight: 853g
Dimensions (L*W*D): 227*143*26mm

Power

Operating Voltage 12V DC
Current Draw < 2,000mA

Configuration

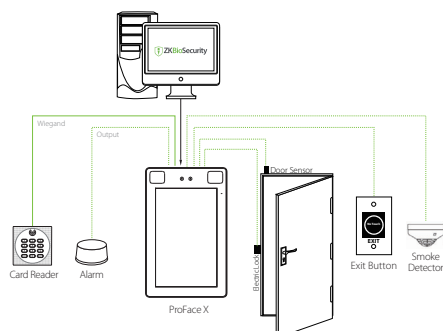

Dimensions (mm)

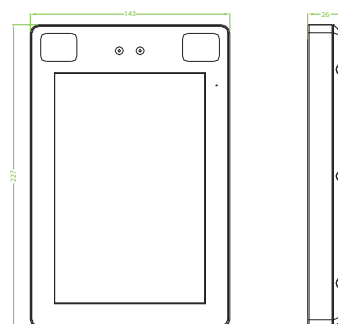

ZKTECO CO.,LTD.
www.zkteco.com
E-mail: sales@zkteco.com

Copyright©2023 ZKTECO CO., LTD. All rights reserved.
V3.0 04/27/2023